

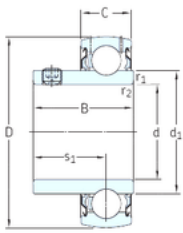

# PCI BEARING LTD

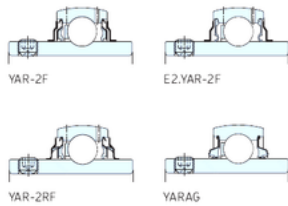

YAT



35 mm x 72 mm x 42,9 mm SKF  
YAR207-2RF/HV deep groove ball bearings

Bearing No. YAR207-2RF/HV

Size	35x72x42.9 mm
Bore Diameter	35 mm
Outer Diameter	72 mm
Width	42,9 mm
d	35 mm
D	72 mm
B	42,9 mm
C	19 mm
d1	46,1 mm
r1 min.	1 mm
r2 min.	1 mm
s1	25,4 mm
Weight	0,42 Kg
Basic dynamic load rating (C)	21,6 kN
Basic static load rating (C0)	15,3 kN
Fatigue load limit (Pu)	0,655

YAR207-2RF/HV Bearing 2D drawings and 3D CAD models