

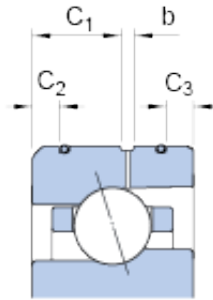

PCI BEARING LTD

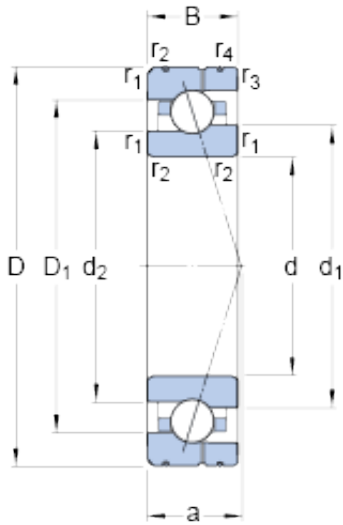

75 mm x 115 mm x 20 mm SKF 7015 CE/P4AL angular contact ball bearings

Bearing No. 7015 CE/P4AL

7015 CE/P4AL Bearing 2D drawings and 3D CAD models

Size	115x75x20 mm
Bore Diameter	115 mm
Outer Diameter	75 mm
Width	20 mm
d	75 mm
D	115 mm
B	20 mm
d ₁	89.28 mm
d ₂	86.8 mm
D ₁	100.72 mm
b	1.8 mm
C ₁	10.9 mm
C ₂	3.4 mm
C ₃	3.4 mm
r _{1,2} - min.	1.1 mm
r _{3,4} - min.	0.6 mm
a	22.8 mm
d _a - min.	81 mm
d _b - min.	81 mm
D _a - max.	109 mm
D _b - max.	110.8 mm
r _a - max.	1 mm
r _b - max.	0.6 mm
d _n	91.5 mm



PCI BEARING LTD

Basic dynamic load rating - C	26 kN
Basic static load rating - C ₀	21.6 kN
Fatigue load limit - P _u	0.915 kN
Limiting speed for grease lubrication	16000 r/min
Limiting speed for oil lubrication	26000 mm/min
Ball - D _w	9.525 mm
Ball - z	26
G _{ref}	8.6 cm ³
Calculation factor - f ₀	9.5
Preload class A - G _A	140 N
Preload class B - G _B	420 N
Preload class C - G _C	840 N
Calculation factor - f	1.1
Calculation factor - f	1
Calculation factor - f _{2A}	1
Calculation factor - f _{2B}	1.03
Calculation factor - f _{2C}	1.05
Calculation factor - f _{HC}	1
Preload class A	65 N/micron
Preload class B	102 N/micron
Preload class C	140 N/micron
d ₁	89.28 mm
d ₂	86.8 mm
D ₁	100.72 mm
C ₁	10.9 mm
C ₂	3.4 mm
C ₃	3.4 mm
r _{1,2} min.	1.1 mm



PCI BEARING LTD

$r_{3,4}$ min.	0.6 mm
d_a min.	81 mm
d_b min.	81 mm
D_a max.	109 mm
D_b max.	110.8 mm
r_a max.	1 mm
r_b max.	0.6 mm
d_n	91.5 mm
Basic dynamic load rating C	26 kN
Basic static load rating C_0	21.6 kN
Fatigue load limit P_u	0.915 kN
Attainable speed for grease lubrication	16000 r/min
Attainable speed for oil-air lubrication	26000 r/min
Ball diameter D_w	9.525 mm
Number of balls z	26
Reference grease quantity G_{ref}	8.6 cm ³
Preload class A G_A	140 N
Static axial stiffness, preload class A	65 N/ μ m
Preload class B G_B	420 N
Static axial stiffness, preload class B	102 N/ μ m
Preload class C G_C	840 N
Static axial stiffness, preload class C	140 N/ μ m
Calculation factor f	1.1
Calculation factor f_1	1
Calculation factor f_{2A}	1
Calculation factor f_{2B}	1.03
Calculation factor f_{2C}	1.05
Calculation factor f_{HC}	1



PCI BEARING LTD

Calculation factor f_0	9.5
Mass bearing	0.65 kg